

A-1033 Quick Start Guide

Manual Foldable Pallet Jack

Rated Load Capacity: 2,200 lbs

Fork Size: 31.5" x 15" [Mini]



Scan the QR Code for more information.

Thank you for choosing our manual foldable pallet jack.

For safe and correct use, please read this manual carefully and follow all instructions, precautions, and prohibitions. Keep this manual for future reference. Product specifications may change without notice. If there is any difference between this manual and the actual product, the product shall take precedence.

TABLE OF CONTENTS

INTRODUCTION

1. Warning
2. Parts Introduction
3. Installation Instruction
4. Inspection & Maintenance
5. Customer Support

1. WARNING

- Special Attention: Size and Load

1. Mini Model Notice

- This product is a mini design with a fork size of only 31.5" x 15". Please ensure your pallet or cargo size matches the product to prevent the load from tipping over.

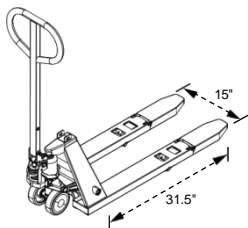

mini

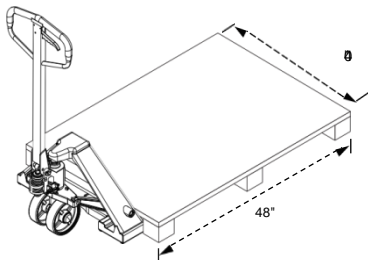

Standard

2. Load Limits

- Do not exceed the rated load capacity.
- The maximum rated load capacity is 2200 lbs.

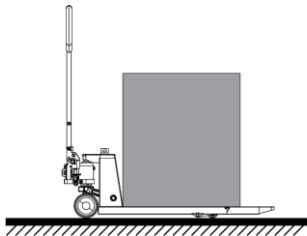

Max. 2200 lbs

3. Center of Gravity

- Place loads securely in the center of the forks.
- Do not lift off-center (i.e., picking up cargo with only one fork tip).

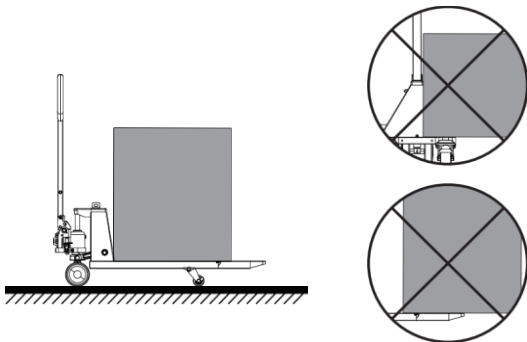

● Operating Environment

1. Ground Requirements: Operate this product only on hard, level, and dry surfaces.
2. Environmental Limits: Do not operate in rainy, humid, or corrosive environments.

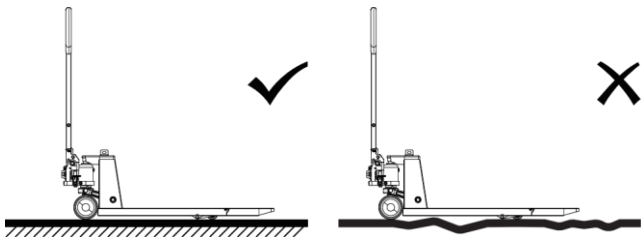

● Folding Mechanism Safety

1.Folding and Unfolding Functions

- Storage: The product features dual folding of the forks and handle. It can be folded to save space when not in use.
- Unfolding: Before use, unfold the forks to a horizontal position, raise the handle upright, and secure it with the locking pin (see Installation Instruction).

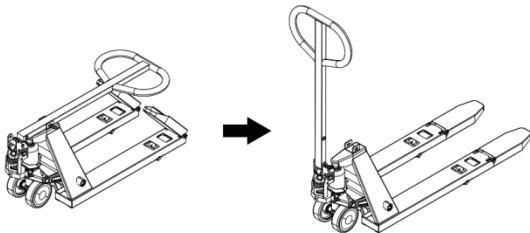

2.Lifting Operation (Lifting)

The product uses a unique foot pedal lever design (no control cable on the handle) to control lifting.

- Lifting Mode: Step on the left side of the lift cylinder foot pedal lever, so the lowering pedal on the right side is released/rebounded.
- Lifting: Grip the handle with both hands and pump repeatedly. The forks will lift smoothly.

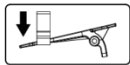
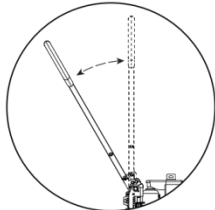
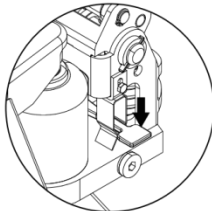
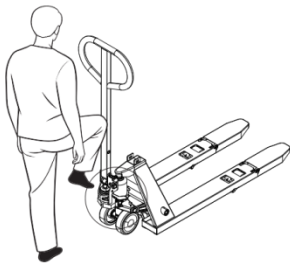

3. Lowering Operation (Lowering)

- Foot Control: Step on the right side of the lift cylinder foot pedal lever. The forks will lower smoothly by gravity.
- Release the pedal to stop lowering.

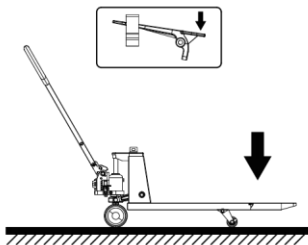
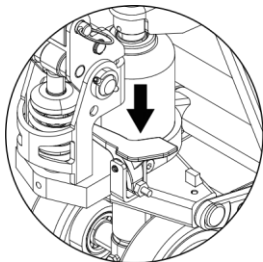

4. Moving and Steering (Moving)

- Pull or push the handle to move the product. Due to its lightweight body and extremely small turning radius, it is highly suitable for narrow spaces.

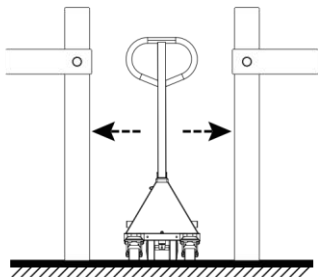
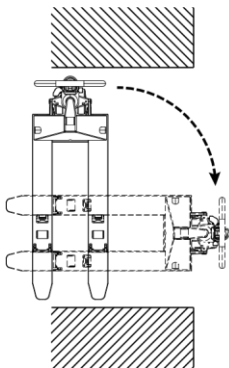

2. Parts Introduction

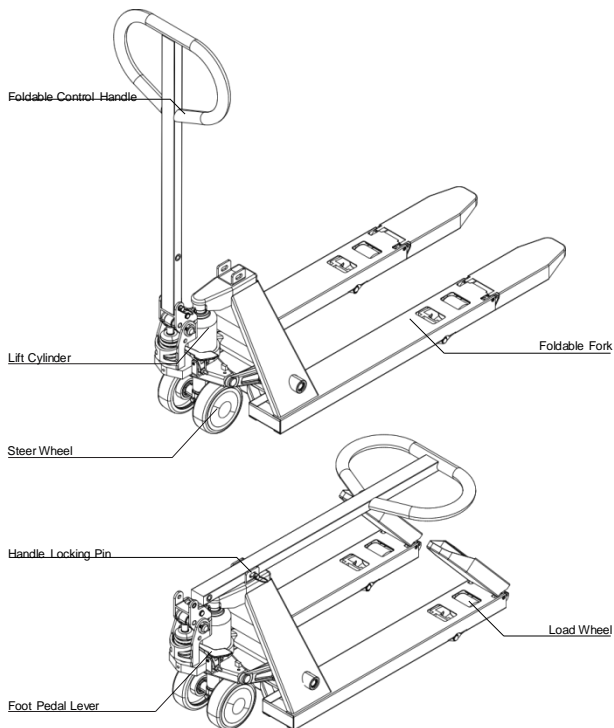

3. Installation Instruction

- The product is mostly pre-assembled at the factory. No complex assembly is required; simply unfold to use.

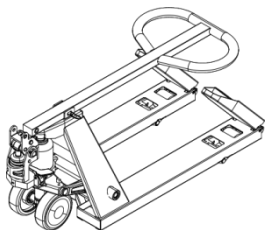

- ① Carefully unpack the product and check the manual and equipment appearance.

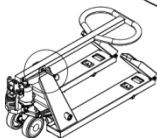
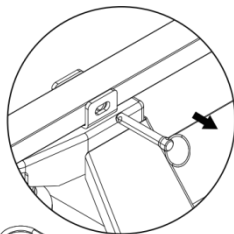

- ② Pull out the handle locking pin (located in the transport storage hole) and pull up the folded control handle.

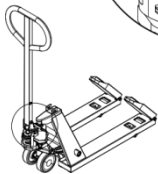
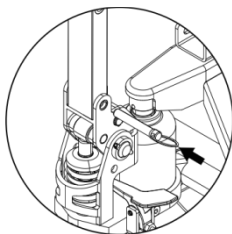

- ③ Align it upright with the base mounting hole, and insert the pin into the locking hole at the connection between the handle and the base.

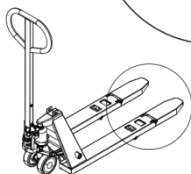
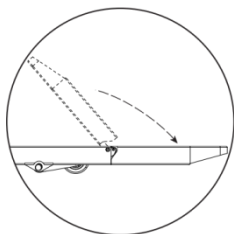

- ④ Flip the folded forks forward and lower them until they rest smoothly on the ground.

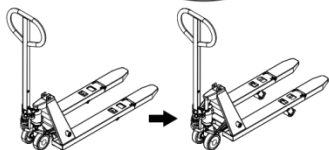
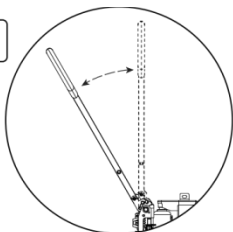

⑤ Step on the left pedal and pump the handle to test if lifting functions normally.

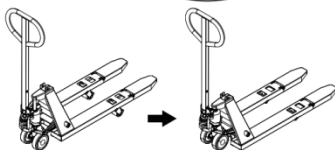
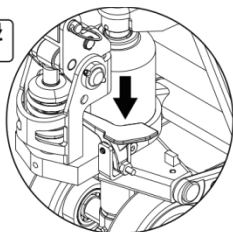

⑥ Step on the right pedal to test if the lowering function is responsive.

4. Inspection & Maintenance

Conducting a thorough inspection of the product can help prevent malfunctions and ensure it achieves its expected service life. Maintenance hours are based on 8 hours of operation per day, 200 hours per month. For safe operation, the product should be inspected and maintained according to the maintenance schedule.

● 200-Hour Inspection and Maintenance

No.	Component	Inspection or Service
1	Overall Condition	Check for abnormalities.
2	Frame & Fastener	Check all bolts, especially on wheels and handle, for looseness.
3	Jack/Cylinder & Oil Pipe	Check for leakage.
4	Wheel	Inspect steer wheels and load wheels for serious wear or entanglement with debris.

● Maintenance Intervals for Consumables and Components

Component	Inspection or Service	Interval (hours)
Hydraulic Oil	Replace	1,600
Seal	Replace	1,200
Bearing	Replace	1,200
Fork Wheel	Replace	1,200
Steer Wheel	Replace	1,200

5. Customer Support

- Warranty Period

1. **New Product (Complete Unit):**

1-year warranty from the date of receipt.

2. **Spare Parts:**

3-month warranty from the date of receipt.

3. **Battery:**

6-month warranty from the date of receipt.

4. **Used Product (Complete Unit):**

3-month warranty from the date of receipt.

- Warranty Coverage

Complete product and its accessories.

- Non-Warranty Items

1. Wearable parts, such as wheels under normal use and fuses.
2. Damage caused by improper or incorrect operation.

1. **Main Sales-after: service@apolloliftus.com**

Main Customer Service: +1 888-801-3049

Working Hours: 9:00 AM to 5:30 PM